



FOR LEASE

Industrial Building

632 Shelley Street
Springfield OR 97477

DETAILS

- Approximately 27,300 square feet
- Adjacent 19,000 square foot fenced yard (shared)
- Available January 1st, 2025
- Zoned LMI (Light Medium Industrial)
- 2 grade loading doors
- \$0.85 per square foot per month, modified gross

**Evans
Elder
Brown &
Seubert**

COMMERCIAL REAL ESTATE

Jeff Elder
jeff@eebcre.com

Ashley Hope Elder
ashley@eebcre.com

(541) 345-4860

Licensed in the State of Oregon.

Overview

632 Shelley Street, Springfield Oregon 97477

Evans
Elder
Brown &
Seubert

COMMERCIAL REAL ESTATE

CONTACT

Jeff
Elder

jeff@eebcre.com

Ashley
Hope
Elder

ashley@eebcre.com

(541) 345-4860

101 East Broadway
Suite #101
Eugene, OR 97401

Licensed in the
State of Oregon.

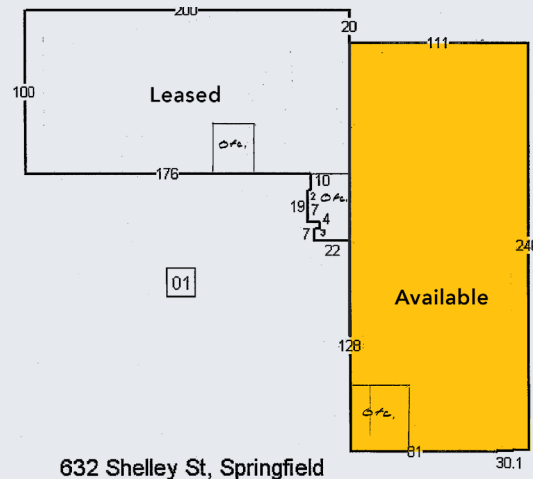

27,300 SF FOR LEASE

- Two (2) grade loading doors
- 400 amp power
- Ceilings 17' - 20' 8"

SITE

- Large parking area
- Adjacent fenced yard - approx. 19,000 sf



Photographs

632 Shelley Street, Springfield Oregon 97477

**Evans
Elder
Brown &
Seubert**

COMMERCIAL REAL ESTATE

CONTACT

**Jeff
Elder**

jeff@eebcre.com

**Ashley
Hope
Elder**

ashley@eebcre.com

(541) 345-4860

101 East Broadway
Suite #101
Eugene, OR 97401

Licensed in the
State of Oregon.



The information in this package was gathered from sources deemed reliable, however Evans Elder Brown & Seubert makes no representation or warranty of the accuracy of the information. Any buyer or tenant considering a purchase or lease of this property should confirm any and all information relied upon in making the decision to purchase or lease prior to finalizing the transaction and bears the risk of all inaccuracies.

Location

632 Shelley Street, Springfield Oregon 97477

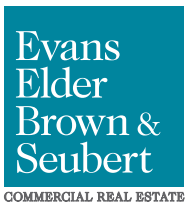

CONTACT

541.345.4860

Jeff Elder
jeff@eebcre.com

Ashley Hope Elder
ashley@eebcre.com