



Building For Sale

1450 High St.
Eugene, OR 97401

Building Profile:

Building Area	8,201 SF
Site SF	29,621 SF
Sales Price	\$3,200,000
Built	1971
Parking	27 stalls
Zoning	General Office (GO)
County	Lane County
Lot No.	17-03-31-41-02900

Features:

- Double Drive-Thru
- 27 Parking Stalls
- Pylon Monument Signage
- Walker's Paradise (97)
- Neighboring: Residential (mainly college housing - single-family & multi-family apts), 7-Eleven, The Barber Shop, Vero Espresso, Toshi's Ramen, Falling Sky Brewing, The Bier Stein, McMenamins High Street Brewery & Café, Safeway, University of Oregon campus, and PeaceHealth Sacred Heart Medical Center

Contact:

Evans
Elder
Brown &
Seubert
COMMERCIAL REAL ESTATE

Jeff Elder
541.345.4860
jeff@eebcre.com

cresa

Kelsey Machuca
503.679.2419
kmachuca@cresa.com

Floorplan

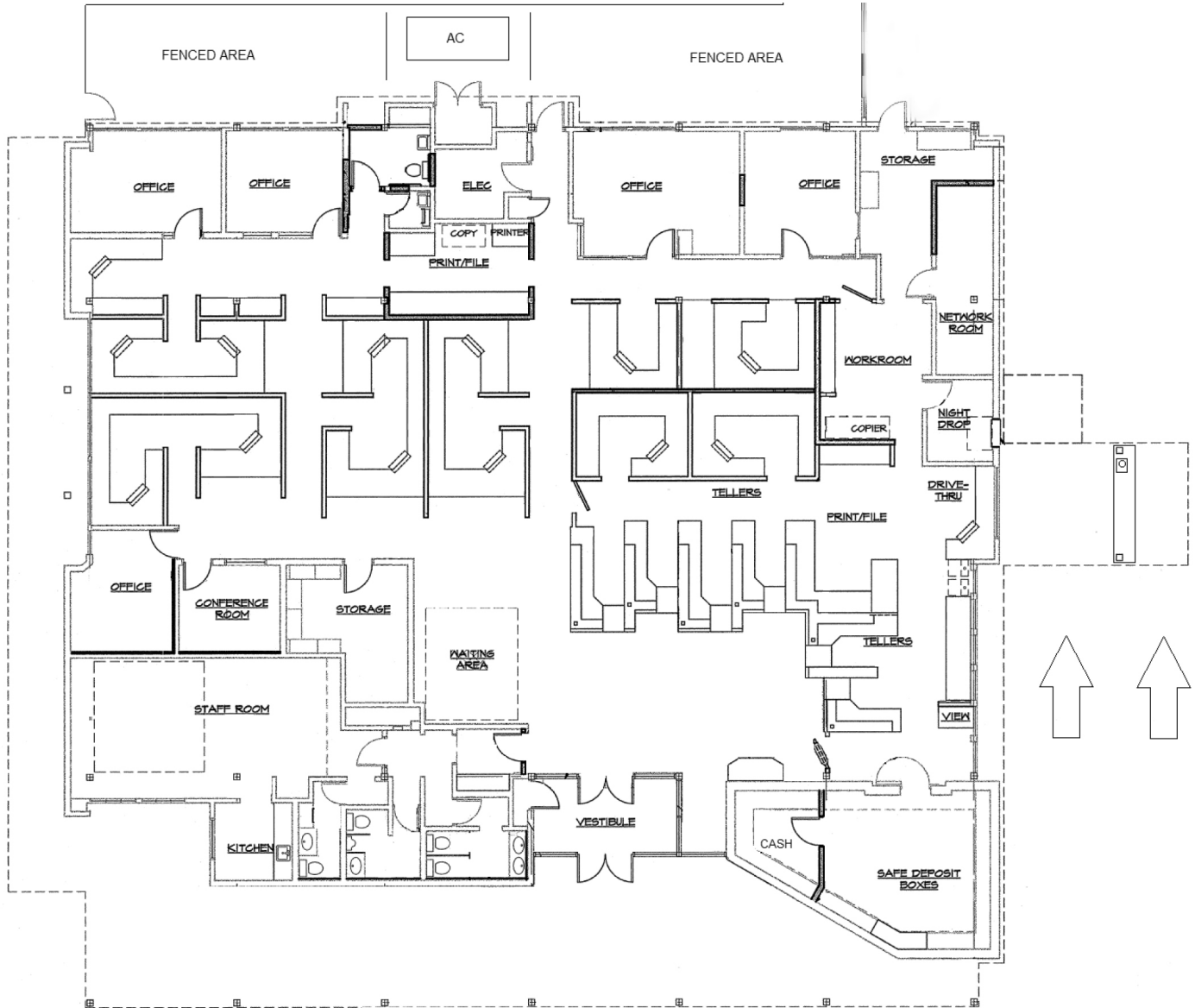

Exterior



Workspaces



Building For Sale

1450 High St.
Eugene, OR 97401

Teller windows



Drive-thru



Vault



cresa

1355 NW Everett St Suite 100 | Portland, OR 97209

cresa.com/Portland

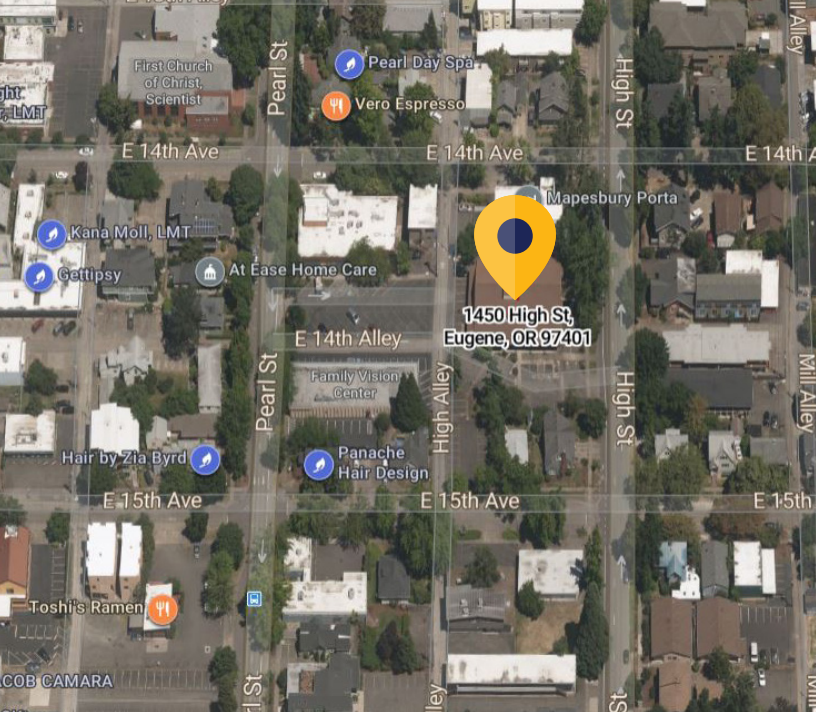

Building For Sale

1450 High St.
Eugene, OR 97401

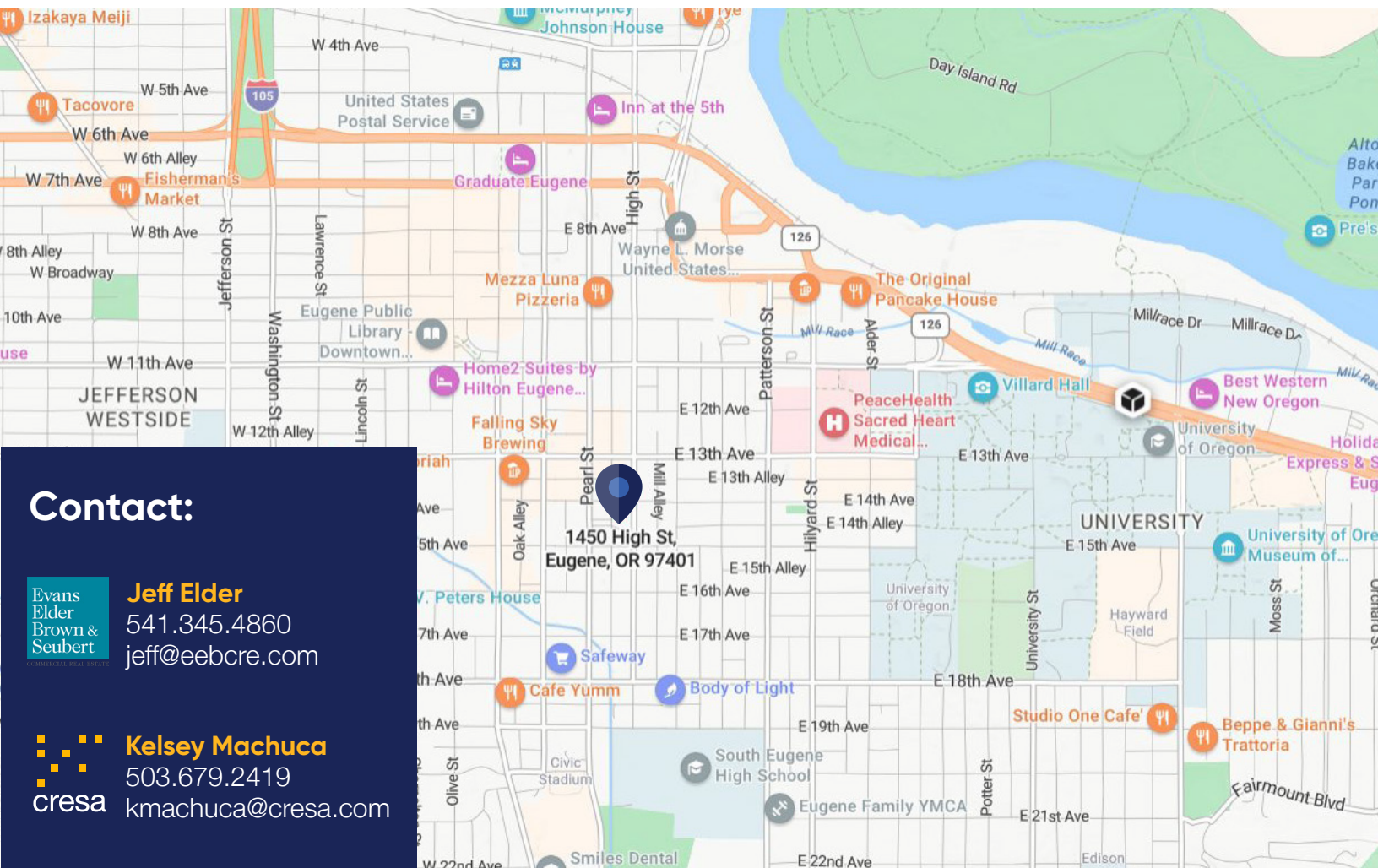

Contact:

Evans
Elder
Brown &
Seubert

Jeff Elder
541.345.4860
jeff@eebcre.com

cresa

Kelsey Machuca
503.679.2419
kmachuca@cresa.com

cresa

Cresa © 2022. All rights reserved. The information contained in this document has been obtained from sources believed reliable. While Cresa does not doubt its accuracy, Cresa has not verified it and makes no guarantee, warranty, or representation about it. It is your responsibility to independently confirm its accuracy and completeness. Any projections, opinions, assumptions or estimates used are for example only and do not represent the current or future performance of the property. The value of this transaction to you depends on tax and other factors which should be evaluated by your tax, financial and legal advisors. You and your advisors should conduct a careful, independent investigation of the property to determine to your satisfaction the suitability of the property for your needs.